

CHECK THIS DRAWING IS THE LATEST REVISION
 THIS DRAWING SHOULD BE READ IN CONJUNCTION WITH ALL RELEVANT DRAWINGS, SPECIFICATIONS, SCHEDULES AND OTHER CONTRACT INFORMATION ISSUED BY THE ARCHITECT, STRUCTURAL ENGINEER, SERVICES ENGINEER AND ANY OTHER CONSULTANT EMPLOYED OR RETAINED BY THE EMPLOYER IN RESPECT OF THESE WORKS.
 ALL DIMENSIONS SHOWN ARE TO THE FACE OF MASONRY, METAL OR TIMBER STUD FRAMING, OR THE CENTRE LINE OF STRUCTURAL OR TIMBER MEMBERS STEEL MEMBERS, UNLESS NOTED OTHERWISE.
 REPORT ANY DISCREPANCIES, CONFLICTS, ERRORS OR OMISSIONS TO THE CA AND SEEK DIRECTIONS BEFORE PROCEEDING.
 CONFIRM ALL DIMENSIONS AND LEVELS ON SITE PRIOR TO COMMENCING WORK. IF IN DOUBT ASK!
 DO NOT USE ANY AREAS INDICATED FOR EITHER VALUATION, PURCHASE SALE OR ANY OTHER FORM OF LEGALLY BINDING CONTRACT.
 DO NOT REPRODUCE ANY PART OF THIS DRAWING WITHOUT PRIOR WRITTEN CONSENT. THIS DRAWING REMAINS THE COPYRIGHT OF ARCHITYPE LTD.

**PURELY INDICATIVE DESIGN
 PLEASE REFER TO THE TENDER SPECIFICATION FOR REQUIREMENTS**

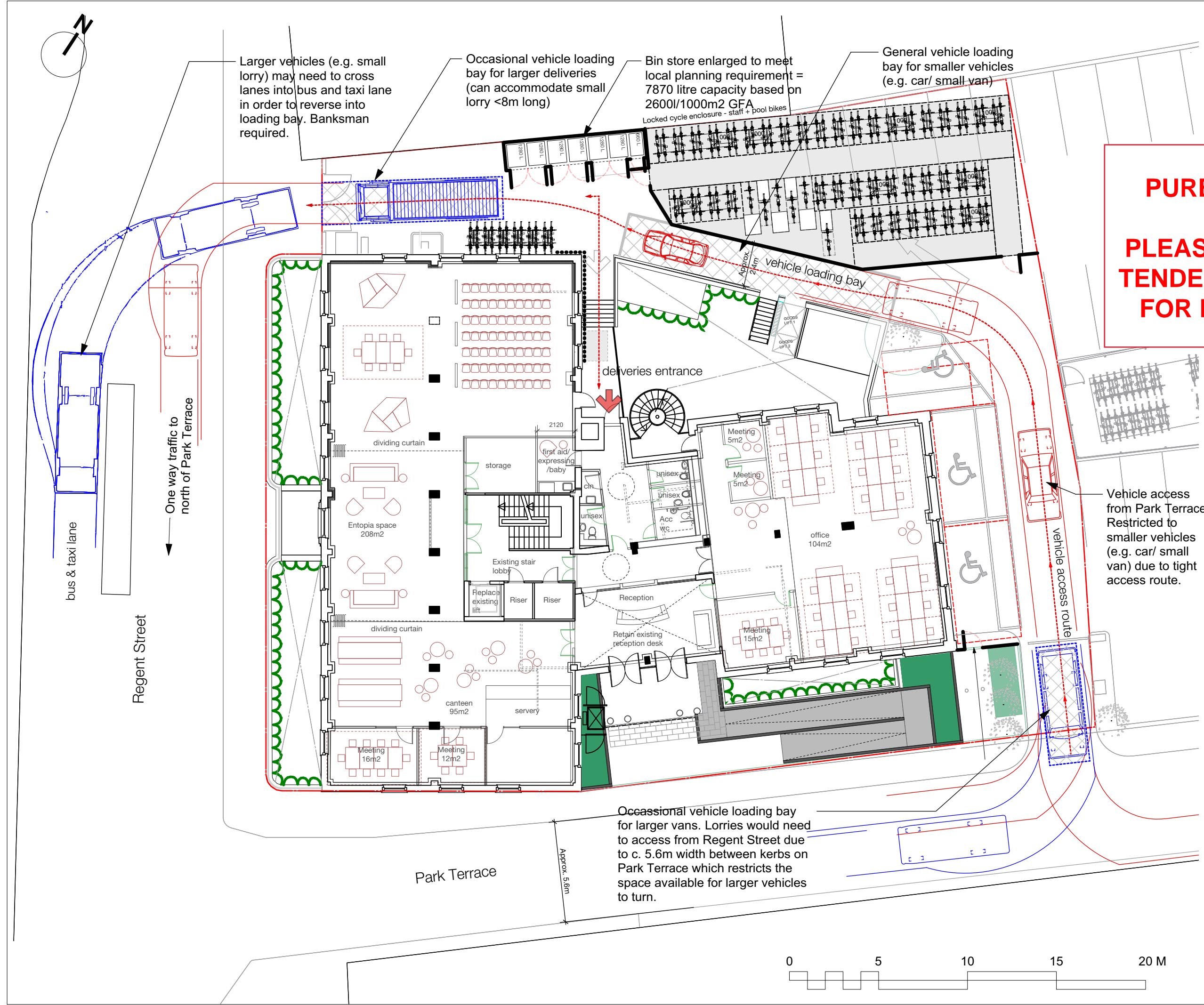

Larger vehicles (e.g. small lorry) may need to cross lanes into bus and taxi lane in order to reverse into loading bay. Banksman required.

Occasional vehicle loading bay for larger deliveries (can accommodate small lorry <8m long)

Bin store enlarged to meet local planning requirement = 7870 litre capacity based on 2600l/1000m2 GFA
 Locked cycle enclosure - staff + pool bikes

General vehicle loading bay for smaller vehicles (e.g. car/ small van)

Vehicle access from Park Terrace. Restricted to smaller vehicles (e.g. car/ small van) due to tight access route.

Occasional vehicle loading bay for larger vans. Lorries would need to access from Regent Street due to c. 5.6m width between kerbs on Park Terrace which restricts the space available for larger vehicles to turn.

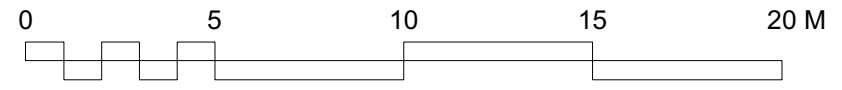

Revisions	
Status	FOR INFORMATION
ARCHITYPE	
The Morocco Store, 18 Leathermarket Street, London SE1 3JA t 020 7403 2888 f 020 7407 5283 e london@architype.co.uk www.architype.co.uk	
Project	CISL
Client	University of Cambridge
Dwg Title	Access and deliveries - Option A
Dwg No	9645_SK190328_03
Scale	1:200@A3
Drawn by	RQ
Date	28 March 2019
Checked by	WB